

APPLICATION SITE OUTLINED IN RED - LAND UNDER SAME OWNERSHIP OUTLINED IN BLUE.

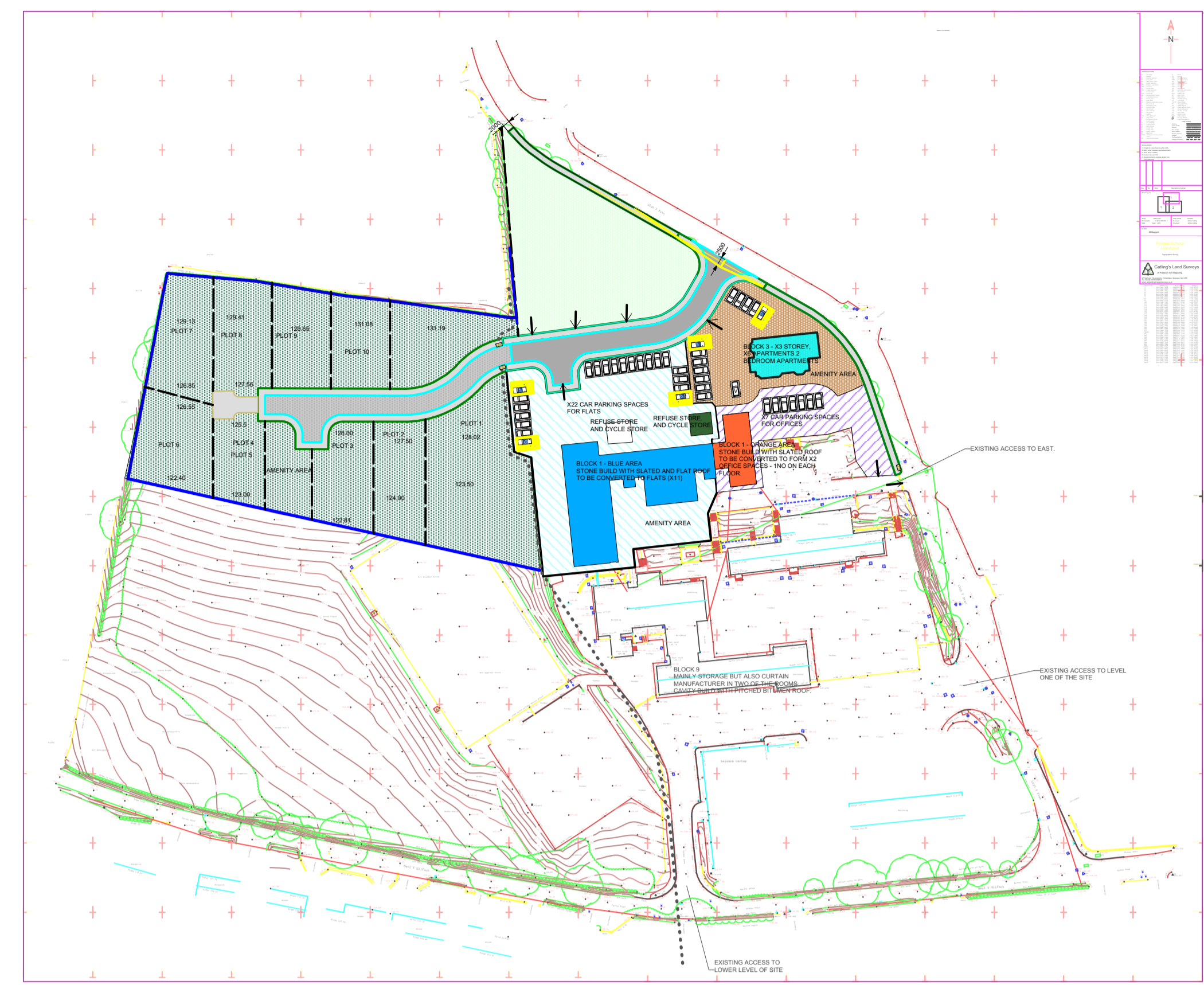

2 PROPOSED SITE PLAN AND DEVELOPMENT TO NORTHERN AREA OF SITE  
Scale: 1:1250

1 EXISTING SITE PLAN  
Scale: 1:1250

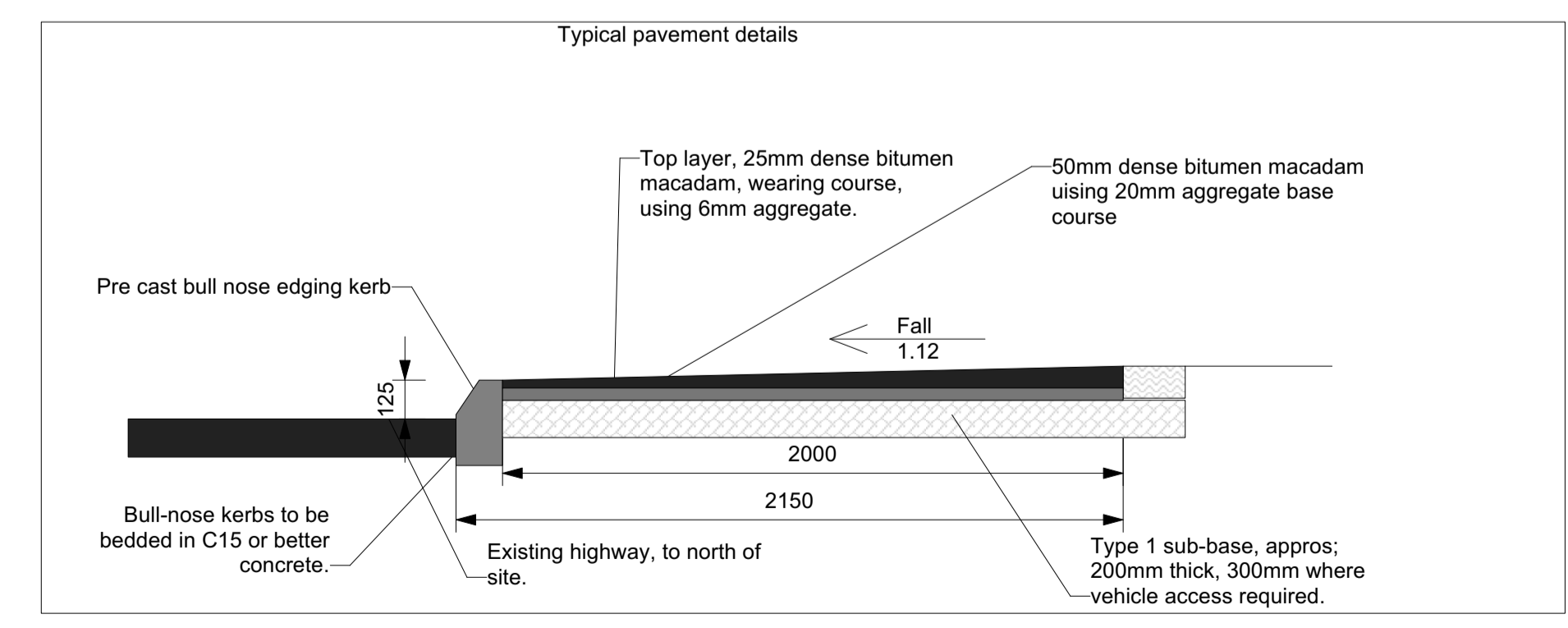
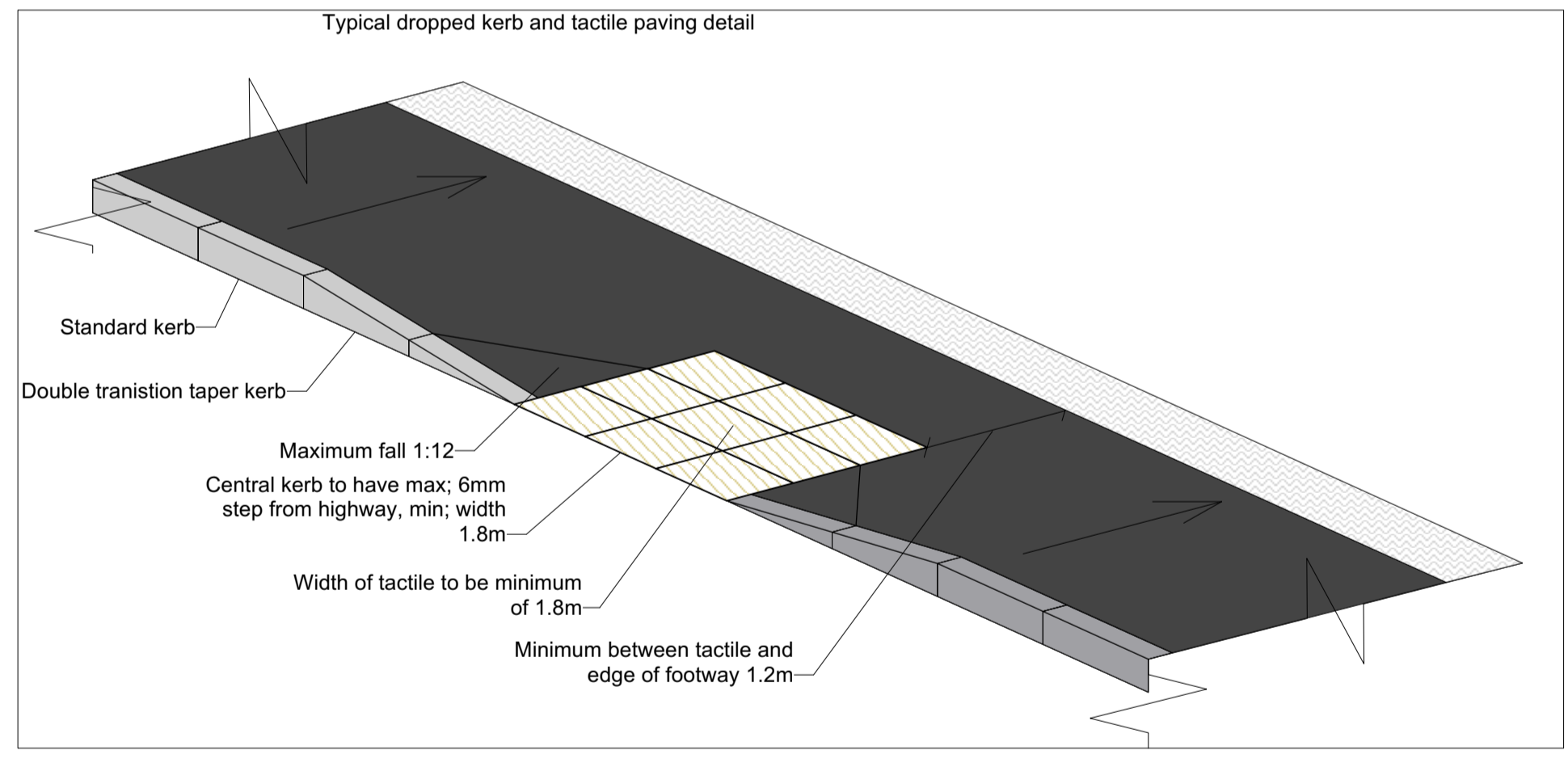

3 TYPICAL DETAILS FOR IMPROVEMENTS TO EXISTING PAVEMENTS  
Scale: 1:20

PL VER 1	10/05/24	All measurements must be checked on site. If there are any deviations the designer should be notified and written confirmation sought.
		The plans are the property of M. Baggott Chartered Surveyors and Architectural Service and written permission must be sought before passing any plans onto third parties.
		Party Wall agreements should be put in place before any works commence on site.

No.	Date	Issue Notes
-----	------	-------------



Design Firm  
Mark Baggott Chartered Surveyors & Architectural Practice  
p. 01559371550  
m. 07717292879  
e. mark@baggottmark.co.uk

Consultant  
Mark Baggott

Project Title  
Proposed development of 'Block 1' at former secondary school, Llandysul, Ceredigion.

Sheet Title  
EXISTING AND PROPOSED SITE PLAN AND TYPICAL PAVEMENT DETAILS

Project Manager	N/A	Project ID	BLOCK 1
Drawn By	MB	Scale	1:100; 1:50;
Reviewed By		Sheet No.	1 of 6
Date	19/04/2024		
CAD File Name	DYFFRYN TEIFI DEVELOPMENTS		PAPER A1